



DESIGN PROJECT

# EARRINGS

"PATINA SPIKE"

# DESIGN PROJECT

## EARRINGS "PATINA SPIKE"



### Swarovski crystals

Article	Product Group	Article No.	Amount	Size	Color	Color Code
	Pendants	6480	2 pcs.	18 mm	Crystal Silver Shade	001 SSHA
	Pendants	6480	2 pcs.	28 mm	Crystal Rose Patina F	001 ROSPA

### Supplies & Tools

- Supplies**
- 2x Bar 3 holes, silver, 16x2.7 mm
  - Chain, silver, 48 cm
  - 2x Ear posts, silver
  - 2x Eye pins, silver
  - 4x Head pins, silver
  - 12x Jump rings, silver, 3 mm
  - 2x Jump rings, silver, 4 mm
  - 2x Jump rings, silver, 6 mm
  - 2x Jump rings, silver, 8 mm

- Tools**
- Flat nose pliers
  - Round nose pliers
  - Side cutter

Level of design: **BEGINNER**

Have also a look at the **text instructions** at the last page!

### STEP 1

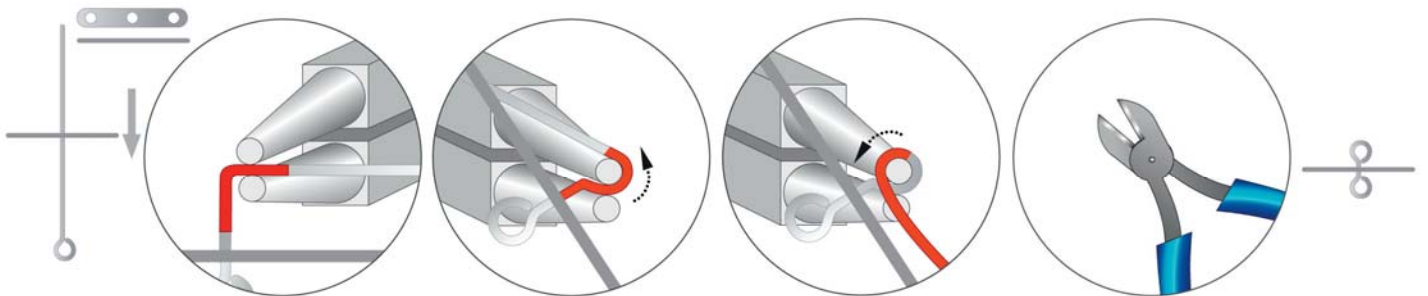

Repeat step x2:



### STEP 2

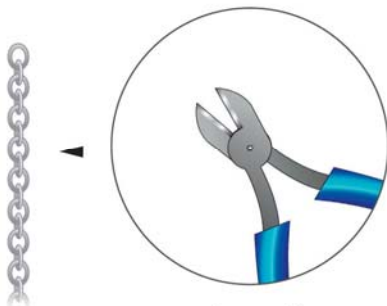

4 cm x2  
15.8 cm x1

STEP 3

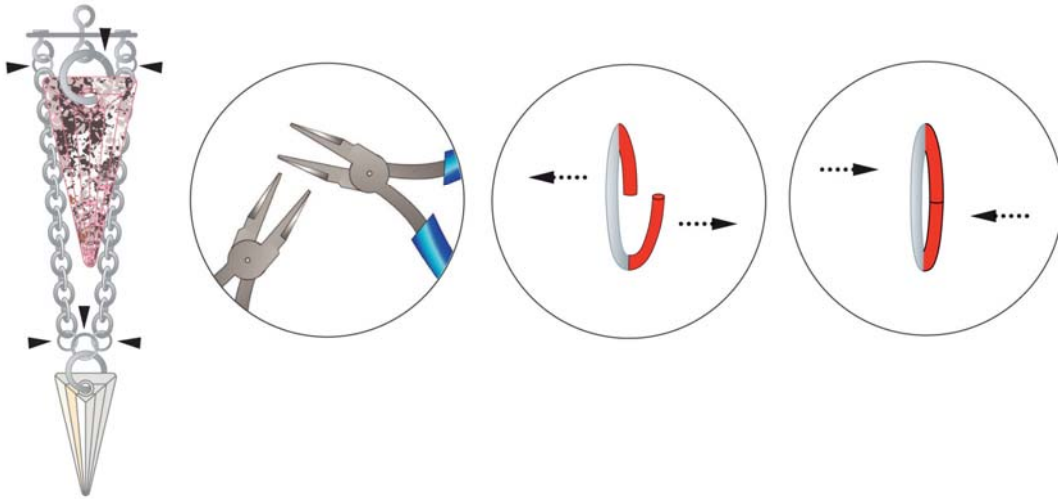

STEP 4

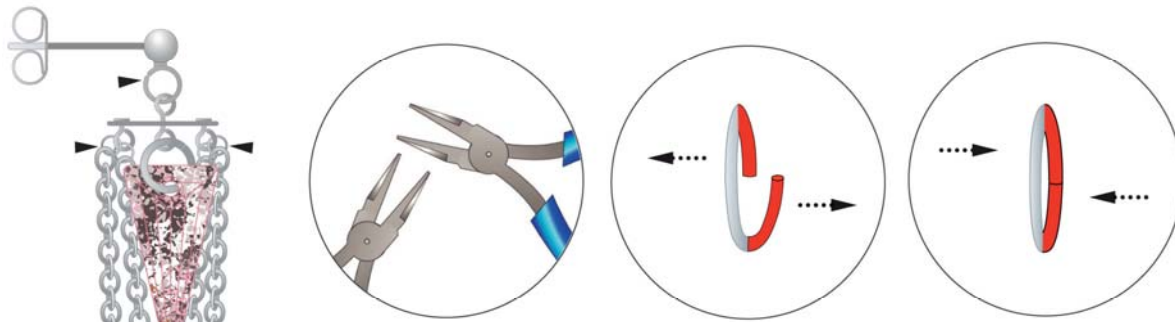

Repeat step 1 - 4 x1:



## DESIGN PROJECT EARRINGS "PATINA SPIKE"



- STEP 1: Insert an eye pin through the center hole of the bar and turn a loop close to the bar. Thread two head pins through the other two holes of the bar and turn a loop near the bar for each one. Trim excess head pin wire on all three.
- STEP 2: Cut two 4cm long and one 15.8cm long chains.
- STEP 3: Attach Swarovski Pendant art. 6480 28 mm Crystal Silver Patina to the loop in the center of the bar using an 8 mm jump ring. Connect the 4 cm long chains to the head pin loops and to Swarovski Pendant art. 6480 18 mm Crystal Silver Shade using a 3, 4 and 6 mm jump rings.
- STEP 4: Connect an ear wire to the center loop at the top of the bar. Connect the 15.8 cm long chain to the loops of the head pin using 3 mm jump rings as shown. Repeat steps 1 - 4 to create the other earring.